





# EXHIBITION TEAM

El Beh / Wang Min  
Mick Mize / Bob Levy  
Elissa Stebbins / Joyce Anderson  
Jomar Tagatac\* / Lin Bo  
Michelle Talgarow / Wang Min Alternate

Nina Ball,\*\* Exhibit Designer – *Setting*  
Wesley Cabral, Exhibit Designer – *Video*  
Christopher Chen, Instigator and Writer  
Christine Crook, Exhibit Designer – *Textiles*  
Perry Fenton, Exhibition Assistant  
Nikita Kadam\*, Stage Manager

Devon LaBelle, Exhibit Designer – *Mixed Media*  
Susannah Martin, Director of Collections and Interpretation  
Ray Oppenheimer, Exhibit Designer – *Illumination Specialist*  
Leigh Rondon-Davis, Curatorial and Exhibition Assistant  
Matt Stines, Exhibit Designer – *Noise Architect*  
Michelle Talgarow, Assistant Director of Collections and Interpretation

## EXHIBIT SPONSORS

Ann Gabor Arancio & Remo Arancio  
Lisa Esherick & Kathy Kahn  
The Grubb Company  
Michael & Gretchen Schnitzer  
Guy Tiphane

## SEASON SPONSORS

Peet's Coffee & Tea  
Carol Amyx & Donald Kaufman  
Kitty Boshier  
Ragesh Tangri & Daralyn Durie

*Caught is generously supported by grants from The Fleishhacker Foundation and The Zellerbach Family Foundation.*

## THANKS

Cliff Caruthers, Paul Cello, Amy Chan, Anne Chen, Kwan Chen, Michelle Chen, Kevin Clarke, Fauxnique, Cindy Im, InterAct Theatre Company, Mellie Katakalos, Felicia King (signature chop design), Charisse Loriaux, Antje Oegel, The Play Company, Lawrence Radecker, Sarah Roland, Sideshow Theatre, Kat Zdan

Originally premiered by InterAct Theatre Company. *Caught* was developed, in part, at the 2014 Sundance Institute Theatre Lab at the Sundance Resort, and at 2by4 Theater in 2013.



\*Member of Actors' Equity Association, the Union of Professional Actors and Stage Managers.

This Theatre operates under an agreement with Actors' Equity Association, the Union of Professional Actors and Stage Managers in the United States.

\*\*Member of the United Scenic Artists Local 829

# MADE IN CHINA

On display at the Ashby Stage.

A pop-up art gallery installation created by Lin Bo and Xiong Gallery artists, *Made in China* is an exploration of perception and identity in the Chinese / American encounter. The exhibit looks at the ways in which globalized consumerism complicates the cultural exchange between East and West, playing its own role in human rights abuses as well as laying the groundwork for a new Orientalism.

**CONTRIBUTING ORGANIZATIONS:** Shotgun Players, The Xiong Gallery

VIDEO AND/OR AUDIO RECORDING OF THIS EXHIBIT BY ANY MEANS WHATSOEVER IS PROHIBITED.

## Xiong Gallery Statement of Purpose · [XIONGGALLERY.ORG](http://XIONGGALLERY.ORG)

we give space and safe haven to artists of Asian descent unable unwilling undesiring of conventional channels

we promote produce present projects that cannot be shown in museums and that infiltrate any and all mediums for broadcast purposes

we defy disrupt dislodge the idea of gallery **you will know our exhibitions when you are in them**



# EXHIBITION MAP

- 1 Deng Hua  
*The Golden Shield*  
Sheng Wong  
*[UN0111000001110010101100111003]/limit*
- 2a Audrey Shu  
*Made in China*
- 2b Audrey Shu  
*Made in America*
- 3a Ming Jiawei  
*We're Ready!*
- 3b Ming Jiawei  
*We're Ready!*
- 4 Lin Shipin Bo  
*I Am Not Myself*
- 5 Fu Zhang Lai  
*Bra Flag*

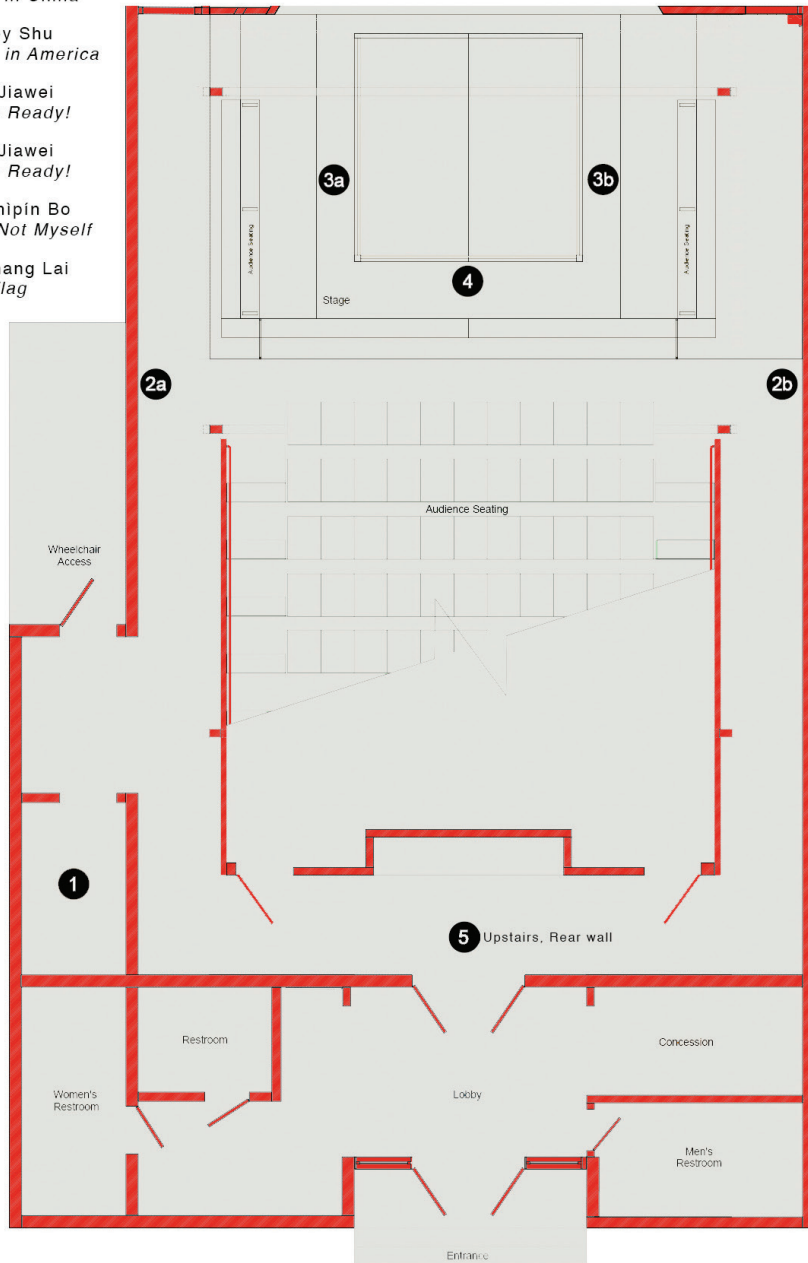

1

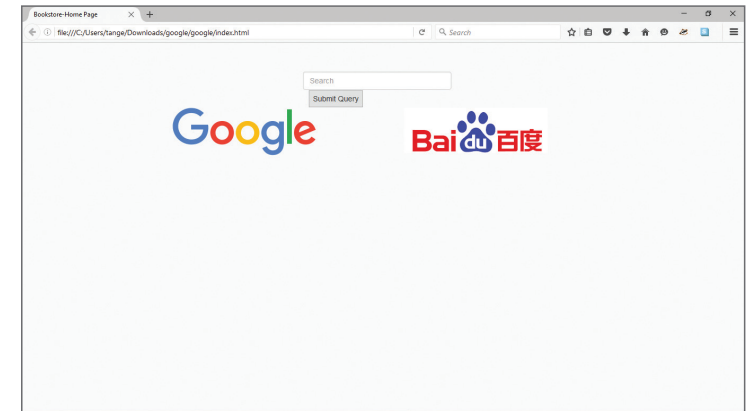

**Deng Hua** (b. 1982)

*The Golden Shield*, 2015

Computer, Internet, paper, wood, sand

Through the looking glass of Internet censorship, this piece seeks to call awareness to the discrepancy in the information reaching the end user behind China's Golden Shield. Through side-by-side comparison between US Google search and the Chinese equivalent, the Golden Shield is revealed as a barrier "protecting" Chinese people from ideas of dissent.

**Sheng Wong** (b. 1987)

*[UN0111000001110010101100111003]/limit*, 2015

Organic noise recording, binary digits, stock computer speakers

The western world's 21st century mode of gathering information (the Internet) remains persistent despite a lack of reliable information. *[UN0111000001110010101100111003]/limit* creates a subtle yet increasing sense of confinement and discomfort in order to explore the auditory, physiological effects of oppression.



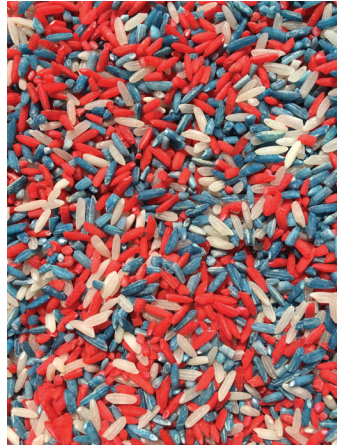
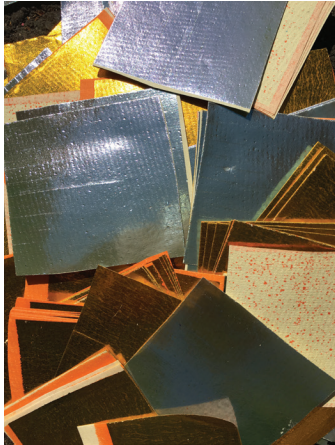

2

**Audrey Shu** (b. 1985)

*Made in China*, 2014

Wire, joss paper, acrylic, PVA, tissue paper

Apple's first iPhone debuted on the American market in 2007. It has since become an icon for innovation, style and technology. The fruit of Apple's efforts is hailed as one of the most desired pieces of American gadgetry. In fact, it is made in China. Behind the Golden Shield, the builders of these products lack the freedom and access to technology that allow their devices to work at their full potential.

**Audrey Shu** (b. 1985)

*Made in America*, 2014

Rice, American milled cotton and thread, alcohol dye

The chief exports to China from the U.S. include grains, rice, and cotton.

The American Reconnaissance Satellite USA 247 was launched in 2015; the logo depicts an octopus encircling the globe. The motto "nothing is beyond our reach" signifies that there is no hiding place for enemies of the USA.

Not even the Golden Shield can keep out the ever-vigilant eye of U.S. surveillance.

3

**Ming Jiawei** (b. 1975)

*We're Ready!* 2014

Digital print on vinyl

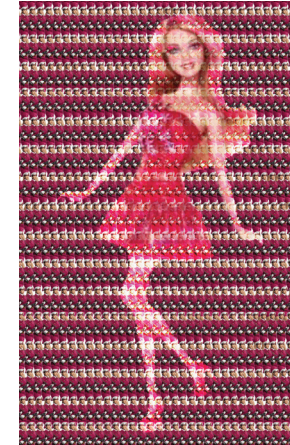

In this series we examine ideas of beauty, of power, of the ideal woman. Who is she?

To the West: the Barbie Doll. Long marketed as an example of female perfection, she is impossibly long and lean, unattainable, and hyper-sexualized. This doll, the Fashionista model, is ready for a night out on the town. She is helpless in her little dress and stiletto heels, seemingly clueless to everything, and without morals.

To the East: the People's Liberation Army action figure. She is beautiful and powerful, truly ready for anything that is asked of her. She is righteous, yet anonymous and without free will... brainwashed.

Both cultures churn out copy after copy of "perfection". Barbie is just one of many American things made by the hands and sweat of armies of Chinese workers in order to feed the insatiable appetite of the West.





4

## Lin Shipín Bo (b. 1979)

*I Am Not Myself*, 2015

Single channel video installation

As a child, Bo's mother was obsessed with Marilyn Monroe. She would spend hours trying to make her face look just like the American pop icon. She wanted to change her hair to blonde, but Bo's father forbade it. Bo's mother believed that Marilyn Monroe possessed ideal beauty.

In changing his face to look like Marilyn Monroe Bo imagines what it would be like to have this kind of longing to look like someone else, to be someone else. Bo created the character of the Chinese policeman to tell the story of someone who lives in two worlds. He is an officer for the Chinese government and he's an artist, a performer. Who is the true person? Are any of the personas true?



5

## Fu Zhang Lai (b. 1977)

*Bra Flag*, 2014

Chinese manufactured bras mounted on fabric

Inspired by the traditions of China's Political Pop movement of the 1990's, *Bra Flag* plays with irony and absurdity by juxtaposing a powerful political symbol (the flag) with a symbol of one of China's most dominant consumer goods (the bra). *Bra Flag* gives voice to the powerless migrant laborers in the sweatshops of China whose lives are abused to create industrial goods that dominate the global market because of their low prices. *Bra Flag* is a confrontation to a capitalist system that values profit first and community last.



The following images are visual aids that accompany the Artist's talk.

1



2



3

4

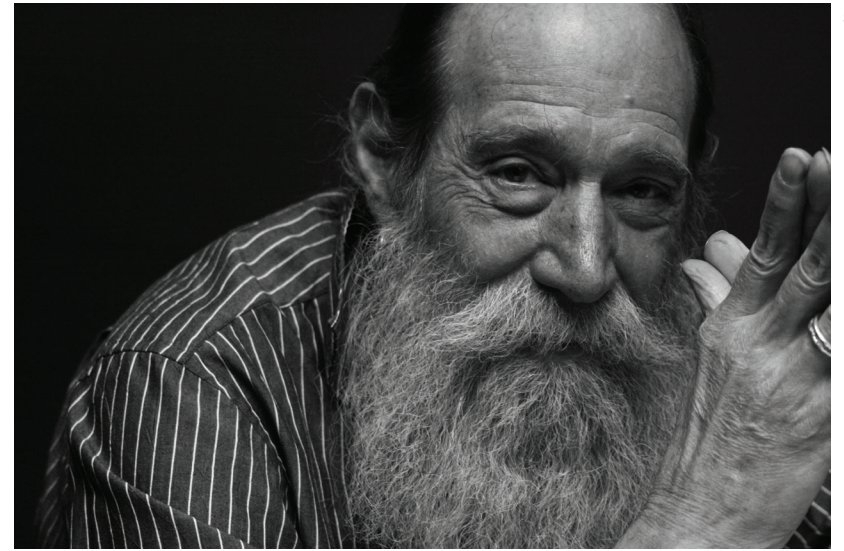

5

6

A GLACIER VANDALIZED

7

AN APPLE MOLESTED



8



9



10



11



## THIS EXHIBIT IS MADE POSSIBLE BY

### ANN GABOR ARANCIO & REMO ARANCIO

Ann and Remo first discovered Shotgun Players in the basement of LaVal's pizzeria. From the beginning they admired Shotgun's innovative, daring style of theatre—they are always willing to experiment. Ann joined the Board of Directors and worked closely with Patrick Dooley for several seasons. Shotgun Players is theatre with great heart. You can meet Ann and Remo at any opening night for a Shotgun Players production—we never miss it.

### LISA ESHERICK / KATHLEEN KAHN

Lisa Esherick has been a painter for 50+ years, and a resident of Berkeley for 25+ years. She came upon Shotgun doing Shakespeare in a parking garage and has been a devotee ever since.

Kathleen Kahn, a retired criminal defense attorney, has been a Shotgun fan (and subscriber) since those early days in the basement of LaVal's. She appreciates the new space, of course, but misses the pizza.

### THE GRUBB COMPANY

The Grubb Company is a full-service boutique real estate firm offering luxury homes in Berkeley, Piedmont, Oakland and Kensington. Since 1964, The Grubb Company has served generations of home buyers and sellers offering the finest services to its clients. A dedicated team of 65 full-time professional agents are based in two offices—Oakland and Berkeley, staffed with highly trained transaction coordinators, a full marketing team and 14 operational staff members, they are sure to make every real estate experience smooth, professional and successful.

### MICHAEL & GRETCHEN SCHNITZER

Gretchen and Mike are pleased to participate as production sponsors of *Caught*, now their 5th season as sponsors. Aside from being part of the audience, they find sponsoring new work the most satisfying way to participate in the Shotgun Community of artists. During time away from Shotgun, Gretchen is a poet while Mike continues as a Financial Advisor at Morgan Stanley in Oakland.

### GUY TIPHANE

Guy Tiphane is always pleased to attend a show at Shotgun Players. He writes at [guytiphane.wordpress.com](http://guytiphane.wordpress.com)



# SHOTGUN PLAYERS SEASON SPONSORS

## CAROL AMYX & DONALD KAUFMAN

### KITTY BOSHER

Even though I have spent my entire life-of-memory on the east coast, for the past 25 years I think nothing of getting on a plane and flying 3,000 miles to see a good play. Much better at setting the stage than actually being on the stage, I am a self-described "appreciator of the arts". (I mean, someone needs to applaud, right?) This 25th Season in Repertory will be the very first time I will be able to see every. single. play. of the entire season and I am giddy at the prospect. Break It Down!

## DARALYN DURIE & RAGESH TANGRI

Daralyn, Ragesh, and their daughter Iona have been privileged to experience some amazing theatre here: *Beowulf*, *Vera Wilde*, *In the Wound*, *Of the Earth*, *Woyzeck*, *The Norman Conquests*, *Strangers*, *Babies*, *God's Plot*, *Antigonick*, *Eurydice*, and (of course) *The Coast of Utopia*. We are pleased to offer our thanks to The Shotgun Players for allowing us to share such a wonderful slice of their first 25 years by helping present the 25th Anniversary Season, and we look forward with excitement, anticipation, and joy to the next 25.

## THE SHOTGUN PLAYERS MANIFESTO

Shotgun Players is a company of artists determined to create bold, relevant, affordable theatre. We believe in theatre that inspires and challenges audience and artist alike to re-examine our lives, our community, and the ever-changing world around us. We are:

### COMPANY

Andy Alabran Nina Ball Fontana Butterfield Kevin Clarke Valera Coble	Christine Crook Patrick Dooley Mark Jackson Liz Hitchcock Lisle Dave Maier	Susannah Martin Joanie McBrien Nick Medina Trish Mulholland Judy Phillips	Richard Reinholdt Katja Rivera Michelle Talgarow Jon Tracy Megan Trout	Matt Stines Beth Wilmurt Hanah Zahner-Isenberg
--	--	---	--	--

### STAFF

<b>Founding Artistic Director</b> Patrick Dooley	<b>Managing Director</b> Liz Hitchcock Lisle	<b>Development Director</b> Joanie McBrien	<b>Production Manager</b> Hanah Zahner-Isenberg	
<b>Box Office &amp; Patron Services Manager</b> Amy Langer	<b>Box Office Associate</b> Daniel Alley	<b>Marketing Director</b> Shereen Adel	<b>Development Associate</b> Brady Brophy-Hilton	<b>Technical Director</b> Chris Swartzell

### BOARD

Jo Golub John Horsch Carolyn Jones	Steve Love Lynn Macdonald	Claire Mosher Richard Nelson Pepi Ross	Michael Schnitzer Ragesh Tangri	Michael Torres Jed Waldman Tamara White
--	------------------------------	--	------------------------------------	---

# SHOTGUN PLAYERS DONORS

The following people made generous donations to Shotgun Players between August 1, 2015 and August 12, 2016. Donors who contributed to our Make a Difference Program are notated with 

## VISIONARIES \$20,000+

Carol Amyx & Donald Kaufman · Kitty Boshier · The Wallace Alexander Gerbode Foundation · The William & Flora Hewlett Foundation · The Kenneth Rainin Foundation · Jason Marks & Pepi Ross  · The Shubert Foundation · Ragesh Tangri & Daralyn Durie  · Tamara White 

## HEROES \$10,000+

Anonymous (1) · The Walter & Elise Haas Fund · Lynn MacDonald  · Patricia & Merrill Shanks  · Guy Tiphane  · Jed & Alison Waldman  · Lucy, Electra, Alex White

## PEOPLE OF ACTION \$7,500+

City of Berkeley Civic Arts Fund · DeYoe Wealth Management · Les & Sue Polgar 

## INNOVATORS \$5,000+

Anonymous (1)  · Nancy Axelrod · Eric Brown & Nguyet Chau  · Michael Choy & Shannon Moffett · The Fleishhacker Foundation · Nina & Claude Gruen  · Al Hoffman & David Shepherd  · Carolyn Jones · John Karnay & Elaine Unemori · Joseph Mallon & Sue Trowbridge · The Sam Mazza Foundation  · Michael & Gretchen Schnitzer  · Bob Fabry & Susan Taylor · Zellerbach Family Foundation





## DYNAMOS \$2,500+

Remo Arancio & Ann Gabor Arancio · Elizabeth Balderston  · The Brickyard C Fund  · Mark Chaitkin & Cecilia Storr · Mavis Delacroix  · East Bay Community Foundation · Kerstin Firmin & Steve Love · Mary-Kay Gamel & Thomas Vogler · Kathleen Kahn & Ken Epstein · Richard Nelson & Janice Berman · Risa & Bruce Nye  · The Bernard Osher Foundation · Thomas Owen · Maggie & Paul Salop  · Stanley & Miriam Schiffman · Lois Schwartz  · Peter Skarpelos & Linda Schmidt · Bonnie Stiles  · George & Kerstin Trowbridge · Jon Wagner & Lynne Hollingsworth · Richad & Kate West 

## THE FEARLESS \$1,250+

Anonymous (1) · Neil, Gene & Crish Barth · Timothy Choate & Elizabeth McKoy · Nancy Wright Cooper · Tom & Jane Coulter · John Dooley  · Lisa Esherick · Jo & Michael Golub  · Joe Gratz & Dinah Sanders  · Chris Hannafan & Debbie Katz  · John & Rachel Horsch · Paula Hughmanick & Steven Berger · John Karnay & Elaine Unemori  · Karin & Greg McClune · Claire Mosher · Russell Nelson · Perforce Foundation on behalf of Gabe Weiss · Ward & Susan Willats · Viviana Wolinsky & Steve Hunter

## MAVERICKS \$500+

Anonymous (3) · Mary Austin & Brewster Kahle · Michelle Barbour · Geoffrey & Sally Bellenger · Cathy Berman  · Carol Bowen · Michelle Bricker & Barry Eichengreen · Holly Brownscombe  · Stan Buller & Virginia Wallace · Joy Carlin · Miss Pamela  · Justin Chen · Murray Cohen, In Memory of Betty Cohen · Helen Conway, In Honor of William Zschaler · Christine Cziko · Michael Darby & Toni Martin · Diane Davenport & Sayre Van Young · Valerie Doyle  · Tracy Ferron · Karen & Hartmut Fokken · Tom & Kelly Fratar · May







Lynne & Timothy Gill · Judith & Alexander Glass  · Ken & Karen Harley · Ann Fischer Hecht & Shawn Hecht · Lisa Hirsch · Joe Kane · Rachel Kayhan · Anne & Marston Leigh · Chris Macomber · Erica Maier D'Ambrosio & Brett D'Ambrosio  · Caephren McKenna, In Memory of Sean McKenna · Ivan & Maris Meyerson · E. Craig & Kathy Moody · Colleen Neff & Helmut Kapczynski · Bill & Jane Neilson · Jeanne & Kiranjit Rana  · Deborah Robbins & Henry Navas · Karen Rosenbaum & Ben McClinton · Brian Bock & Susan Rosin · Karen Saginor · Laura Scheffow  · David Roberts & Gail Simpson · Jacqueline Smalley · Jennifer Sousae · Andy Spear · John Stroik · Mark Wasserman & Judy Freeman · Henry Trevor & Elizabeth Werter · Judith Wilber & Bob Miller  · Steven Winkel & Barbara Sahm · George & Kathy Wolf · Charles & Nancy Wolfram

## PROVOCATEURS \$250+

Anonymous (3) · Abbey Alkon & Jonathan Leonard · Donald & Peggy Alter · Rachel Anderson · Barbara Anderson & Gordon Silvera · William & Susan Bagnell · Victoria & Ken Ball · Barbara Baxter · David Beery & Norm Abramson · Lance Belville & Lynn Lohr · Benevity Community Impact Fund · Carol Bledsoe & William Pursley · Jennifer Bowyer  · Richard and Alice Brown · Gail & Eric Buchbinder · Susan & Ronald Choy · Jean Circiello · Ronald Clyman & Francoise Mauray · Barbara De Janvry · Amelia Ellis  · Joan Emery & Eddy Rubin · Sheila Faraghan · Brigitte & Louis Fisher · Morgan Forsey · Gordon & Barbara Frassinelli · Mary Gorski · Nina Handler · Alan Harper & Carol Baird · Michael & Elayne Isaacs · Naomi Janowitz & Andrew Lazarus  · Philip & Patricia Jelley · Unhei Kang  · Martin & Linda Kelp · Amelia Krause  · Todd & Pamela Lane · David Madson · Jill H. Matichak · Sheila McCormick & Paul Herzmark · Richard & Susanne Monson · Erica Nietfeld · Thomas O'Brien · Linda Oliver & Tom Montgomery · Evan Painter & Wendy Polivka · Henri Picciotto & Irva Hertz  · James & Kristen Policy · Gina Pulice & Aaron Krasner · Philip & Carla Reed · David Reid & Jayne Walker · John Stern · Cameron & Einar Sunde · Elsa & Revan Tranter · Stephen Van Meter · Jacqueline Volin · John S. Waller · Robert & Emily Warden · Mark Wasserman & Judy Freeman · Tom & Penny Whent · Gail Wiemann  · Laurie Zahner & Eric Isenberg

## INSTIGATORS \$125+

Anonymous (4) · Mark Aaronson & Marjorie Gelb · Denise Abersold · Robert Alto · Oscar Anderson · Elisabeth Andreason & Melissa Allen · Debbie Arthur & Jeff Soller · Lee Aurich & Helen Hutchison  · Tamar Yehoshua Baskin Family Foundation · Norm Berzon & Janet Hinze  · Christopher Bowen · Kate Brady · David and Pamela Bullen · Jacob Burnim · Caroline & Rande Burton · Miriam Ciochon · Karen & Stephen Clayton · Thomas Diettrich  · Vin Dunn & Judy Casey · Ann Einstein · A. Grant Elliot & Sharon Elliot · Barbara Epremian · Gini Erck & David Petta · ExxonMobil Foundation · Mary Eaton Fairfield · Tom Ferrell & Meg Vasey · Cynthia Flow-Callies · Michael & Katie Frassinelli · Barbara Fritz · Kelli Frostad · Neil Goldstein & Sylvia Spears · Laura Gorjance · Josephine Gray · Mark Greenside & Donna Umeki  · Lee & Patrick Hackett · Ilse Hadda · Alberta Hankenson · Tracy Haughton · Sharon Jue & David Wells · Karen Saginor & Abbe Kalos · Catherine Karrass & Margo George · Linda Katz · Kevin Kelly · Russell Kirk  · Dan Klang & Jean Waxdeck · Kara Knafelc · Martha Kokes · Connie Krosney · George Maguire · Len & Pat Marabella  · Albert Martin · David & Ellen McCaig · Robert & Elizabeth Mitchell · D.G. Mitchell · Sharon Morrison · Patricia & David Munro · Frank Murray · Cindy Nakashima · Rebecca Pauling · Stephanie & Charles Peters  · Ellen Peterson  · James Pine · Mary-Anna Rae · Eddie Reynolds & Ed Jones · Ellen Robey & Joel Lutzker · Elizabeth Rosenberg · Geri Rossen · Josh & Anita Rotenberg · Marilyn & David Rowland  · Richard Russell · Deborah Dashow Ruth in Memory of Leo Ruth · Gretchen Saeger · Leida Schoggen & Buck Farmer · John Shepherd & Katharine Gale · Mary Shields  · Sally & Bernard Sklar · Don Smith & Jane Mickelson · Eve Solomon  · Shelby & Vicki Solomon · Gloria Sparrow · Sharon Toth & Gary McDole · Peter Washburn · Diane & Josh Wirtschafter · Mei Wong & Gregg McGlinn

## CONSPIRATORS \$50+

Robert & Keren Abra · Haroon Adalat · Gertraud Albert · Joel Altman · Gene & Nancy Alward · Jon Anderson · Jane Ashland · Dorothy Atkinson · Bruce Avery · Robert Bales · Greg Barker · Natasha Beery & William McCoy · Tom Bekefy · Leora Benioff & Keith White · Joanne & Alan Bernstein · Law Office of Steve Birnbaum · Daniel Bittker · Claudia McDonagh · Pamela Blake · Elliott Block · Zoey Bloom · Brendan Bond · Monika Boros · Patricia Bourne · Will Bradbury · Shella Brenner · Bob Bridges  · Marit Brook-kothlow · Wendy Brucker · Larry Bruno · Amy Burditt · Dan Callaway & Karen Laws · Robert Campbell · Perforce Foundation on behalf of Reece Carmona · Daphne Carvela · Paul Cello · Weikai Chang · Katherine Chavez · Michael Cheng · Jennifer Childs · Alexander J. Chis & Claudette Bégin · R Cho · Ayn & Michael Cimino  · Damion Clark · Sarah Clegg · Stephen & Christie Coffin · Amy Cohen · Steve & Wendy Cook · Michael Cudahy · Anthony Cullen · Nicholas Dale · Abigail De Kosnik · Lideway DeVries · Denice Dennis · Morgan Dill · Gabriel Dillon  · Wendy & George Draper · Melinda Drayton · Carmen Egido & Abel Weinrib · Marina Eisenbud · Kristi Elkins · Kevin Elstob · Jacob Ervin · Ilse & Jim Evans · Lynn Fahselt · Mary Farrant · Sara Felder · Vince Fernandez · Kristin Fisher · Jerry Fishman · Brigitte Fitzsimmons & Marilyn Braiger · Pamela Flood & Steven Shafer · Vince Flores · Cathy Franco · Nancy Friedman & Terry Hill · Wendy Friefeld · Katherine Fritz · Barbara Frost · Gloria Frym · Lydia Gans · Charles Gary & Mary Walters · Hal & Pat Gelb · Susan George & Miles Epstein  · Peter Glazer · David Lance Goines · Stuart Gold · Nora Goodfriend-Koven & Edwin Reano-Vasquez · Marianna Goodheart · Gary Goodman  · Amy Gorman · Harry Gould · Michael Grade · Lucy Gray · Cecily Gray  · Joan Greer · Craig Griffeath · Michele Grim · Mara Hampson · Tom Hansen · Connie Hartung · Kenneth Hempel · Laurel Hermes · Richard & Valerie Herr  · Hilary Holmes · Christina Holmes · Steven Horn · Monica Howarth · Estie & Mark Hudes · Wade Hughan · Kevin Hughes · Krista Hutchens · Susan Irvine · Richard James · Rosemary Jenckes · Arthur Kaneko · Donna & Gary Kasprovicz · Alexandra & Rob Katzenstein  · Laura Kelley-Weakley · Philippa Kelly · Jane & Tom Kelly · Emily Kenyon & David Lipsky · Doug & Allison Kidder  · David Kiddoo · Sang Kim · Christine Kinavey · Sara King · Jacquelyn Kingsley · Peggy Kivel · Lori Kohlstaedt & Glen Lindwall · Diana Krampf · Carol Lashof & William Newton · Zane Lazer · George Lazo · Deborah Lewis & Marty Myers · Deborah Lichtman & Kenneth Frankel · Mark Liss & Bonnie Burt · Laurie Lober & Jerry Szymczak · Aaron Loeb & Kathy Roberts · Peter & Jennifer Lowood-Livingston · Jane Lundin · Jo Magaraci · Jeanie Maier · Linda Maio & Rob Browning · Carol Mancke · David Margolies · Warren McCausland, in Memory of Sean McKenna · Julie McCray · Daniel McLoughlin · Joy Meads · John & Patricia Mengel · Maeve Metzger · Jeff Miner · Mary Mlynek · Victoria Monfried · Samuel Morse · Jerry Mosher · Nancy Moss · Phoebe Moyer · Patricia Mulholland · Sue Mulvihill · Brian Murrell & Diana Quintal · Douglas Newkirk · Freeman Ng · Shannon Nornhold · Anne Ogonowski · Lorraine Olsen & Val Hendrickson · Bob & Diane Olson  · Michelle Oram · Ann & Frank Orme · Tova Osborne · Elizabeth Parra · Encian Pastel · Christine Penfield · John & Janet Petroni · Sally Pincus · Beth Pirkle · Christopher Pissarra & Gail Giffen · Jeff Pollet · Sam Porter · Audrey Powers · William Purcell · Jean Rabovsky  · Karen Racanelli · Mahika Rangnekar · Kathryn & Herb Ranharter · David Reinertson · Charles Rice · Margaret Rienzi · Suzanne Riess · Richard Riffer · William Roberts · Robyn Roberts · Lynn Robertson · Jonathon Rockman · Erin Rockmore · Elizabeth Rogers · Frances Rosario · Marjorie Roth · Susan & Robert Roth · Kathy Rucker · Joanna Sabatini · Mira Salas · Carolyn Sanders · Clifford & Pat Saunders · Phyllis Brooks Schafer · Bobbi Schear · Marge Schnitzer  · Taylor Schreiner · Kyle Schriener  · Laura Schulkind & Dan Perlstein · John Selawsky & Pamela Webster · Marcia Settler · Neel Shah · Jane Shamaeva · Sean Sheridan · Alan Shindel · Gae & Melvin Shulman · George Siedel · Sharon Silva & Kristin Krueger · Harriet Simpson · Lisa Sitkin · Jocelyne Sleckman · Sherry Smith · Patricia Smith · Jeffrey & Chris Smith · Cindy Snyder  · Henry Sobel & Susan Bessler · Laura Soble · Teri Steele · Anne Stenzel  · JoAnn Strang · Karen Sugiyama · Walter Norton & Joan Sullivan · Michael Swernoff · Harry & Betsey Tabraham · John Taylor & Ruth Palmer · Lawrence Taymor · Elizabeth Trask · Connie & Brian Tremblay · Jamie Vasta · Marcia Vastine · Peggy Volenec · Gretchen vonDuering · Leslie Waggoner · Travis Walter · Michael Watts · Joan Wernett · Daphne White · Evan White · Shelly Willard · Barbara Winslow · Joanne Winter & Adrian Elfenbaum · Ellen Winters · Carla Wolfe · Louise & Jack Wright · Dennis Wulkan · Stephen Yeh · Ann Zatsman · Marisha Zeffer



SHOTGUN PLAYERS'  
**CHAMPAGNE  
STAGED READING**  
SERIES

Two couples from Houston embark on a camping trip, not realizing how ripe they all are for transformation. Things quickly go awry when one of the four campers goes missing and a mysterious half-Cherokee enters their campground. The three remaining campers begin to question what they find valuable in their lives, and whether or not it is possible to commit to a different kind of life.

We give our actors just enough staging and tech to get started and then we let adrenaline do the rest!

# CHEROKEE

WRITTEN BY **LISA D'AMOUR**

DIRECTED BY **MICHELLE TALGAROW**



SEPTEMBER 19 & 20

CALL 510.841.6500 OR VISIT [SHOTGUNPLAYERS.ORG](http://SHOTGUNPLAYERS.ORG)

MTC FIFTIETH ANNIVERSARY SEASON

SEPT 8 - OCT 2

5-TIME TONY AWARD &  
PULITZER PRIZE-WINNER

MTC  
50

MISERY LOVES FAMILY

# AUGUST: OSAGE COUNTY BY TRACY LETTS

[MARINTHEATRE.ORG](http://MARINTHEATRE.ORG) | 397 MILLER AVE, MILL VALLEY | 415.388.5208

THEATREFIRST

2016-17 SEASON

WE ARE THE MAPS OF OUR WORLD



[THEATREFIRST.COM](http://THEATREFIRST.COM)

Thank you Shotgun Players  
for continuing to create  
memorable theater  
for our community.

The GRUBB Co.  
REALTORS

[GRUBBCO.COM](http://GRUBBCO.COM)

3070 Claremont Avenue | Berkeley | 510.652.2133

1960 Mountain Boulevard | Oakland | 510.339.0400



¡FEED LA REVOLUCIÓN!

VEGAN MEXICAN FOOD

3031 ADELINE ST IN BERKELEY

510-981-8081



**UP NEXT ON THE ASHBY STAGE**

**SHOTGUN  
PLAYERS  
PRESENTS**

**WHO'S  
AFRAID  
OF  
VIRGINIA  
WOOLF?**

**OH, IT'S A REAL FUN GAME.**

**WRITTEN BY EDWARD ALBEE DIRECTED BY MARK JACKSON**

PRODUCTION SPONSORS AL HOFFMAN, DAVID SHEPHERD & BONNIE STILES • LYNN MACDONALD • DEYOE WEALTH MANAGEMENT  
25TH SEASON SPONSORS CAROL AMYX & DONALD KAUFMAN • RAGESH TANGRI & DARALYN DURIE • KITTY BOSHER

FOR TICKETS | [SHOTGUNPLAYERS.ORG](http://SHOTGUNPLAYERS.ORG) | 1901 ASHBY AVE  
INFORMATION | OR CALL 510.841.6500 | SOUTH BERKELEY  
RESERVATIONS

**BEGINS OCTOBER 12**